

## SUB-TRANSMISSION

# SHIFT SELECT LEVER/CABLE

### DISASSEMBLY/ASSEMBLY

Remove the instrument panel (page 2-23).

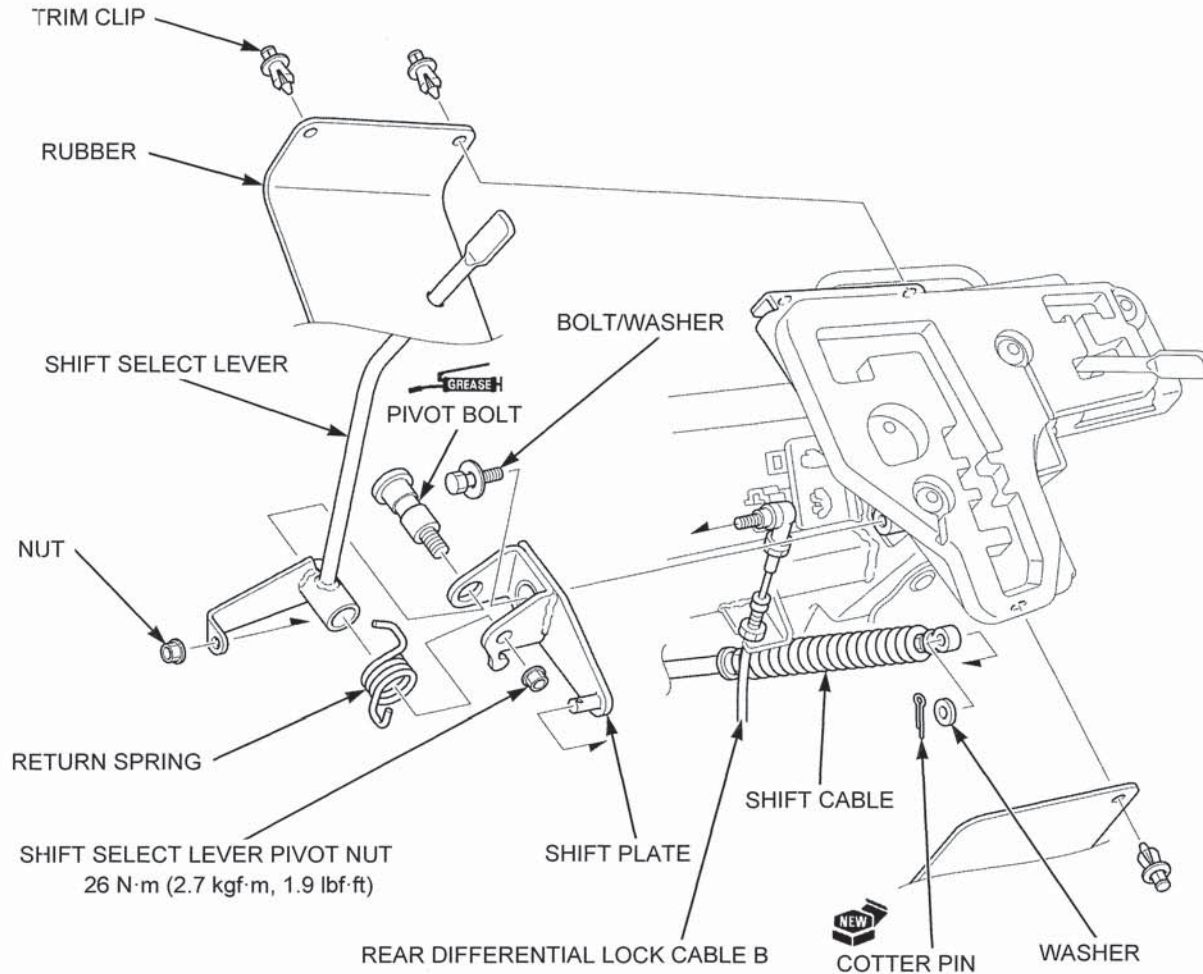

#### NOTE:

- Always replace the cotter pin with a new one.
- After installation, adjust the shift select lever freeplay (page 12-28).

### SHIFT SELECT LEVER FREEPLAY ADJUSTMENT

Remove the battery (page 22-4).

Remove the front seat cushion (page 2-4).

Remove the front fender lid [1].

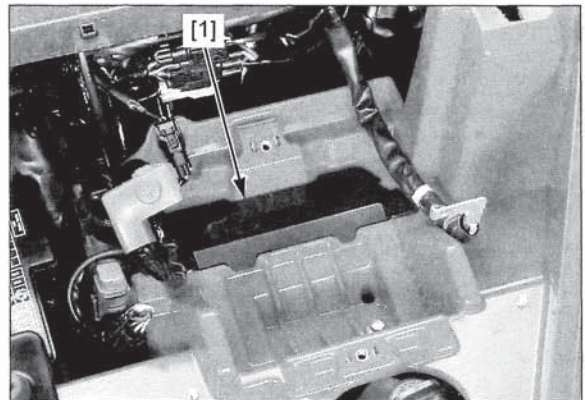

Move the shift select lever to the "N" (neutral) position.  
Move the mode select lever to the "2WD" position.

Loosen the shift cable upper adjusting nut [1] and lower adjusting nut [2].

Temporarily install the battery (page 22-4).

Turn the ignition switch ON (I) and check that the gear position indicator indicates "N" (neutral).

If gear position indicator does not indicate "N" (neutral), operate the shift arm [3] by hand and shift the sub-transmission into the "N" (neutral) position.

*Do not move the shift select lever from the neutral position.*

Without applying force to move the cable, gradually screw the adjusting nuts together by hand until they touch the cable holder [4].

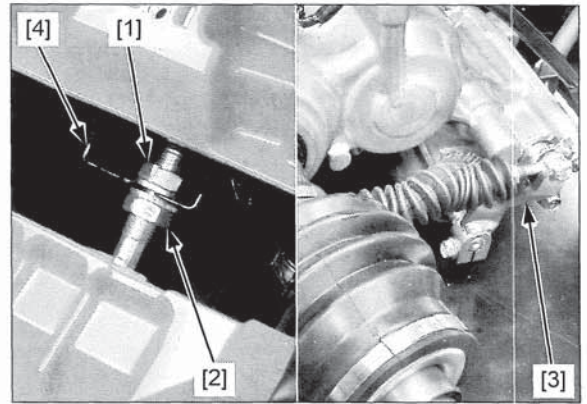

Adjust the shift select lever freeplay when the indicator indicates "N" (neutral) by turning the adjusting nuts [1].

**FREEPLAY: More than 2 mm (0.01 in)**

Tighten the nut while holding the other nut to the specified torque.

**TORQUE: 26 N·m (2.7 kgf·m, 19 lbf·ft)**

After adjustment, check that the shift select lever operates properly.

Install the removed parts in the reverse order of removal.

