



# INSTALLATION INSTRUCTIONS

Accessory

**AUXILIARY LIGHTS**  
P/N 0SV31-HL3-201

Application

**SXS700M4/M2**

Publication No.

**MII 14607**

Issue Date

**November 2013**

**Honda Dealer: Please give a copy of these instructions to your customer.**

## PARTS LIST

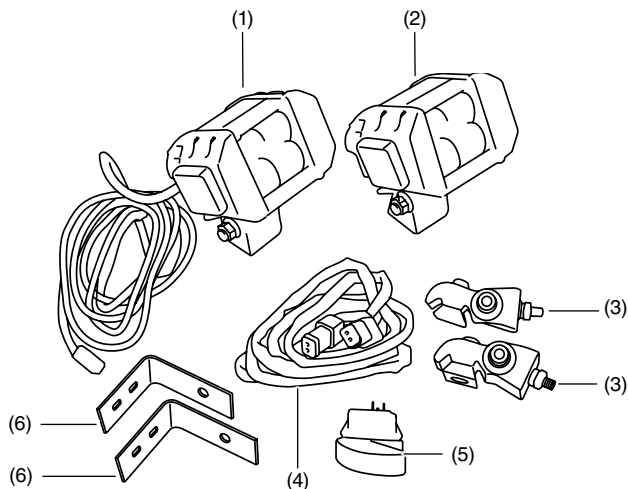

No.	Description	Qty
(1)	Auxiliary light, passenger side	1
(2)	Auxiliary light, driver side	1
(3)	Light mount	2
(4)	Wire lead	1
(5)	Switch	1
(6)	Windshield bracket	2

### AUXILIARY WIRE HARNESS (Sold Separately)

P/N 0SA30-HL3-100

The Auxiliary Wire Harness is required for the installation of this accessory.

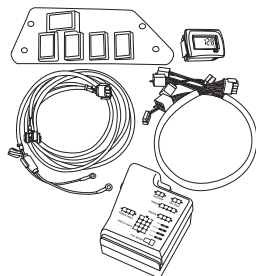

### GLASS WINDSHIELD (Sold Separately)

P/N 0SU95-HL3-105

The Glass Windshield is required for mounting this accessory with the included windshield brackets.

### OPTIONAL LIGHT BAR AUX. CLAMP (Sold Separately)

P/N 0SV31-HL3-201A (38 mm)

0SV31-HL3-302A (41 mm)

0SV31-HL3-301B (44 mm)

Optional bar clamps are available for mounting this accessory to the cab frame or front bumper.

## TOOLS REQUIRED

Hex wrench (5 mm)

Open end wrench (13 mm)

Torx socket (T15)

## TORQUE VALUES

Tighten all screws, bolts, and nuts to their specified torque values. Refer to the Service Manual for the torque values of the removed parts.

## USE AND CARE INFORMATION

- Regularly check the mounting bolts and clamps and retighten them as necessary.
- Regularly check that all wires are not frayed or exposed. Repair any damaged wires immediately.

## INSTALLATION OF AUXILIARY LIGHTS TO THE GLASS WINDSHIELD

1. Remove the Torx screws from windshield on both sides.

Install the windshield bracket with the Torx screws as shown on both sides.

TORX SCREW



WINDSHIELD BRACKET

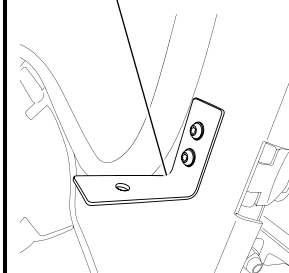

2. Install the driver side auxiliary light and its mount to the driver side windshield bracket. Install the passenger side auxiliary light and its mount to the passenger side windshield bracket.

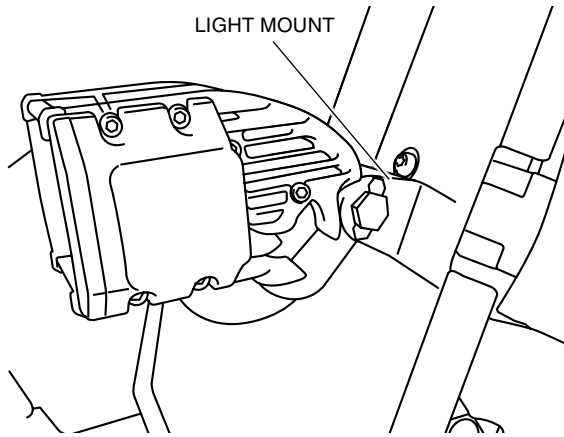

## INSTALLATION OF AUXILIARY LIGHTS TO THE CAB FRAME OR FRONT BUMPER

1. Install the engagement block of the light mount onto the auxiliary light.

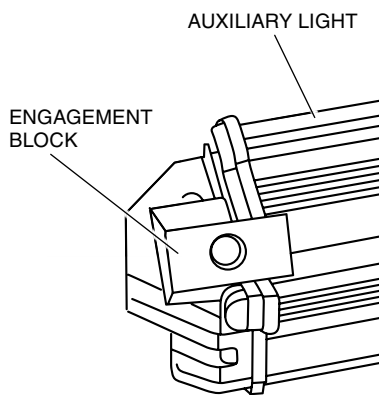

2. Attach the light mount to the engagement block.

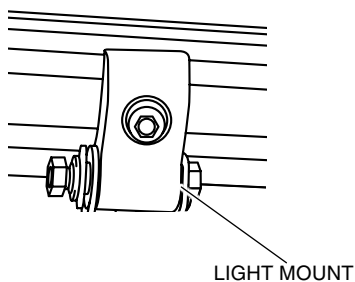

3. Install the appropriate size light clamp to the light mount.

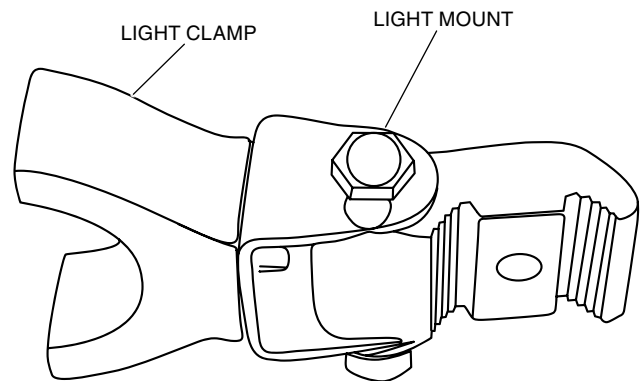

4. Install the assembled auxiliary light/clamp assembly to the desired location on the cab frame or bumper tube.

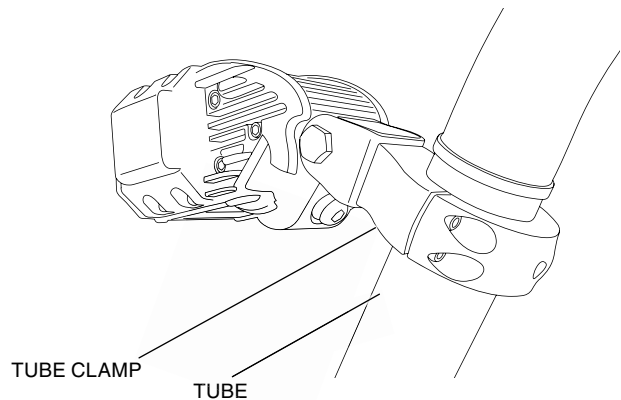

5. Adjust the auxiliary light to the desired beam angle.
6. Tighten the set screw on the underside of the clamp when the desired position is achieved.

## ELECTRICAL CONNECTIONS

### NOTE:

- Fully install the Auxiliary Wire Harness before making the electrical connections for this accessory.
- Route the wire lead between the two auxiliary lights and connect each end of the wire to each light.
  - Install the supplied switch to the Auxiliary Wire Harness Switch Panel and connect the switch to the appropriate connector of the Auxiliary Wire Harness.

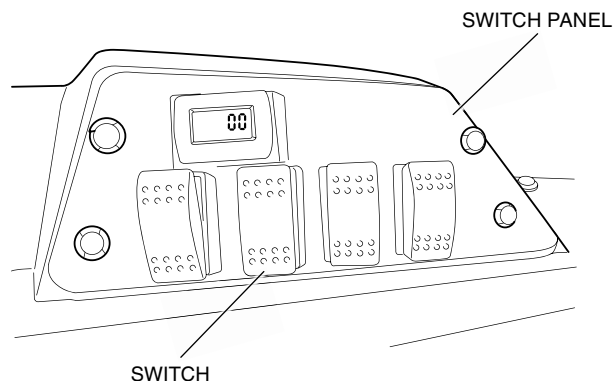

- Route the passenger side auxiliary light wire into the Auxiliary Wire Harness fuse box and connect it to the *AUX LIGHT* connector of the fuse panel.

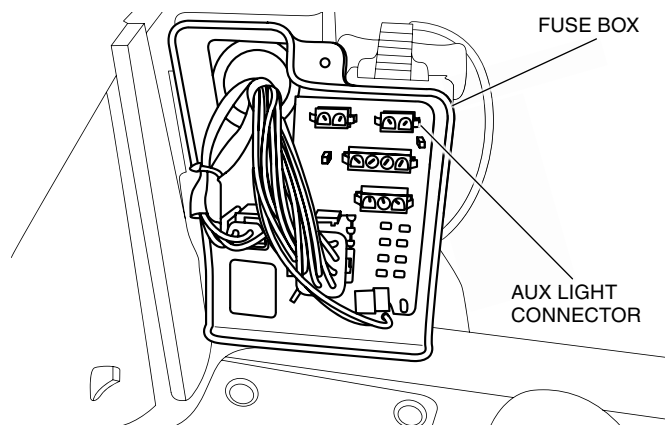

- Make sure a 5 amp fuse is installed in the *AUX LIGHT* position of the fuse panel.

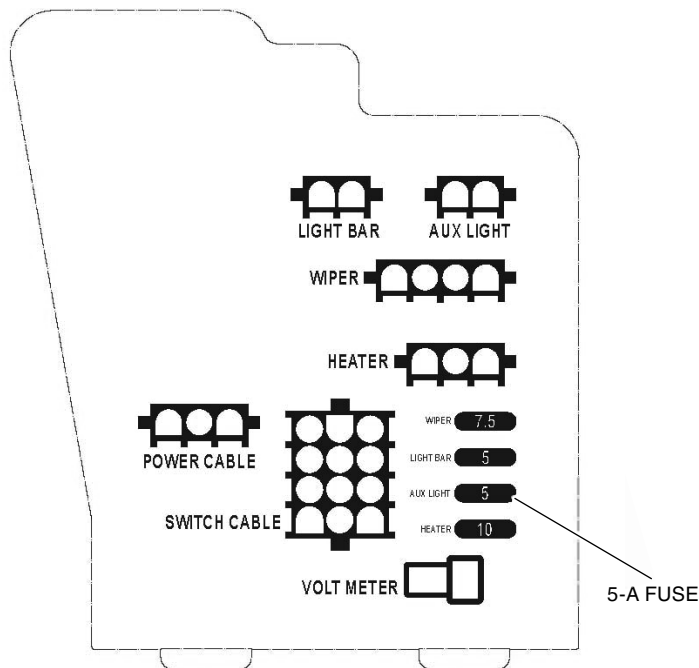

- Check the routing of the auxiliary light wires and make sure they do not interfere with any hot or moving parts.  
Secure the wires to the cab frame tubes with zip ties.