



INSTALLATION INSTRUCTIONS

Accessory
FABRIC FRONT DOORS
P/N 0SR90-HL4-212A
(BLACK)
P/N 0SR90-HL4-222A
(CAMO)

Application
**SXS1000M3/M3P/M3L/
M5P/M5D/M5L**

Publication No.
MII 16820
Issue Date
November 2018

Honda Dealer: Please give a copy of these instructions to your customer.

PARTS LIST

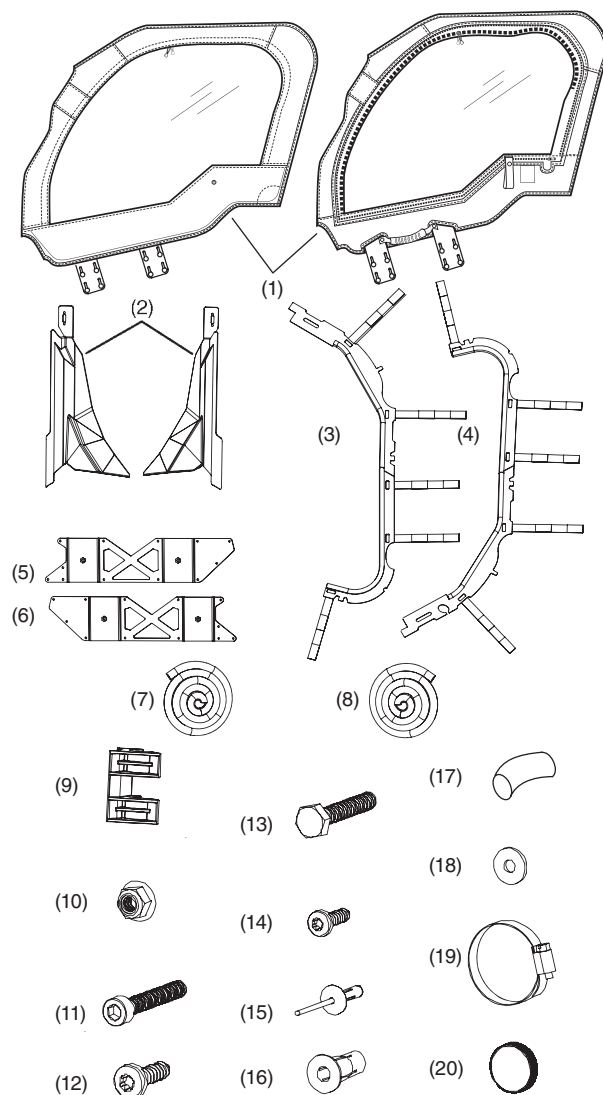

No.	Description	Qty.
(1)	Fabric Door (left and right side)	1 ea.
(2)	Lower OPS cover (left and right side)	1 ea.
(3)	Upper OPS seal piece (left side)	1
(4)	Upper OPS seal piece (right side)	1
(5)	Left door bracket	1
(6)	Right door bracket	1
(7)	Self-adhesive (SA) ball seal	1
(8)	Self-adhesive (SA) foam tape	1
(9)	Door retainer	2
(10)	8 mm flange nut	1
(11)	6 × 40 mm socket head bolt	2
(12)	6 × 10 mm button head bolt	4
(13)	6 × 40 mm hex bolt	1
(14)	#14 × 19 mm bolt	4
(15)	Bulb rivet	24
(16)	6 mm Jacknut	2
(17)	Rubber sleeve	2
(18)	6 mm fender washer	4
(19)	Hose clamp	2
(20)	Thumb screw cap	2

NOTE:

Fabric doors must be installed in combination with a windshield/windscreen and a fabric or hard roof.

TOOLS REQUIRED

Gloves
Safety Goggles
Punch or Awl
Drill
Drill Bit (5 mm, 9.5 mm) (3/16 in & 3/8 in)
Open end wrench (10 mm, 14 mm)
Flat blade screw driver
Rivet setting tool
Vice or Press

USE AND CARE INFORMATION

- Completely read and understand the instructions before installing this accessory.
- Do not tow the vehicle on an open trailer with this accessory installed, as the accessory is not designed for use at highway speeds.
- To clean, sponge with mild soap and cold water, rinse with a hose and allow it to drip-dry.
- Do not machine wash or dry.
- Use mild detergent to remove stubborn stains.
- Routinely clean and lubricate the window zippers.
- Clean the zipper using a toothbrush with soap and water and rinse as needed to keep it free of dust and dirt. Once the zipper has dried, lubricate the teeth using beeswax.

NOTICE

- This accessory will create the need for more frequent air cleaner maintenance. Service the air cleaner daily when operating in dusty conditions.

If the vehicle is equipped with accessory color panels on the front doors, refer to the service manual for the vehicle, remove the accessory color panels to install this accessory. Reinstall the color panels after this accessory installation is complete.

INSTALLATION

1. Assemble the two thumb screws.

Using a vice or press, press the thumb screw caps onto the 6 × 40 mm socket head bolts.

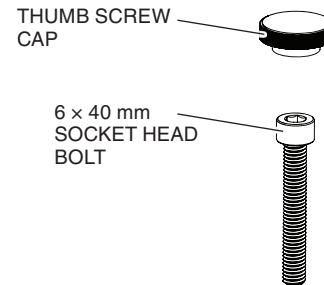

2. Assemble the two hose clamps and rubber sleeves by sliding each rubber sleeve onto the hose clamp as shown.

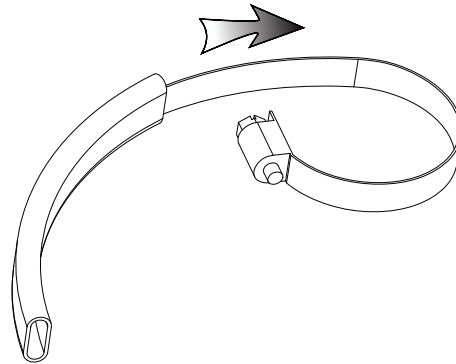

3. Remove the three trim clips from the plastic body panels at the bottom the left front frame tubes as shown.

Install the left lower OPS cover onto the plastic body panels at the bottom of the left front frame tubes as shown.

Reinstall the trim clips through the lower OPS cover into the body panels as shown.

Install the right side OPS cover using the same procedure.

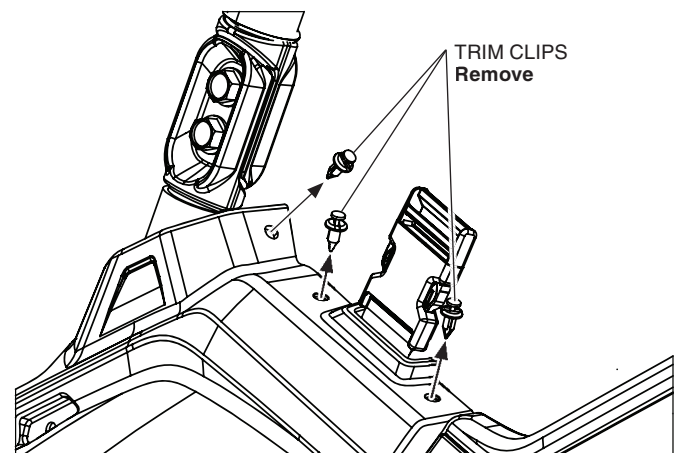

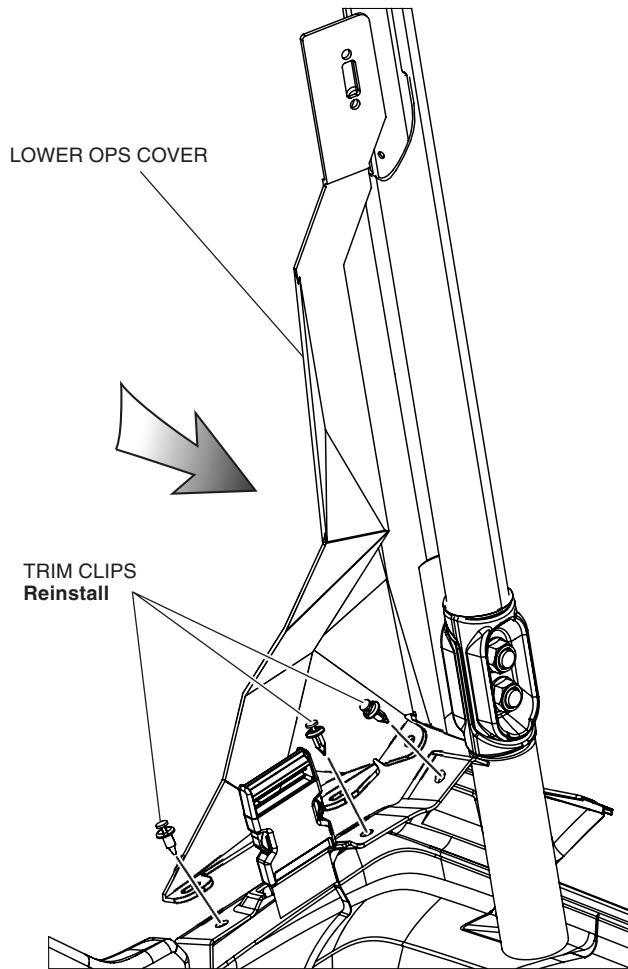

4. Test fit the SA Ball Seal to the Lower OPS Covers at the position shown, and then trim the SA Ball Seal to the correct size. Do this on both sides.
Remove the adhesive backing and press the SA Ball Seal onto the Lower OPS Covers at the position shown. Do this on both sides.

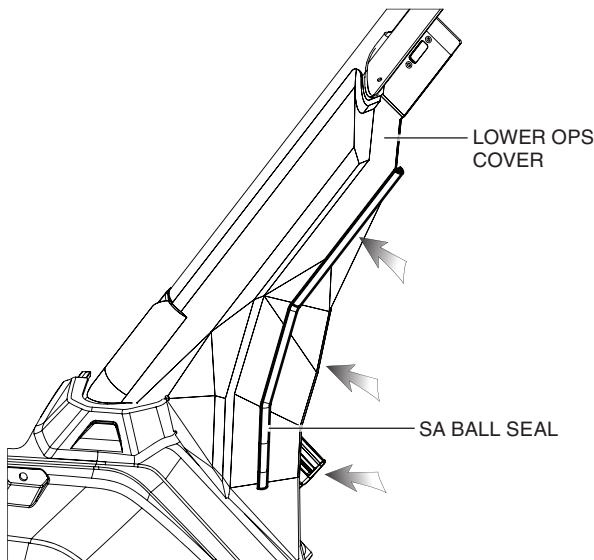

5. Install the left upper OPS seal piece to the inside of the upper frame tubes. Locate the seal piece by inserting the tabs into the slots under the safety net mounting locations as shown.

Thread each hook and loop strap out through the hole in the seal piece, around the frame tube, back through the hole in the seal piece, and then back to itself.

Install the right upper OPS seal piece using the same procedure

NOTE:

The right side upper OPS seal piece has a cut out for the grab handle.

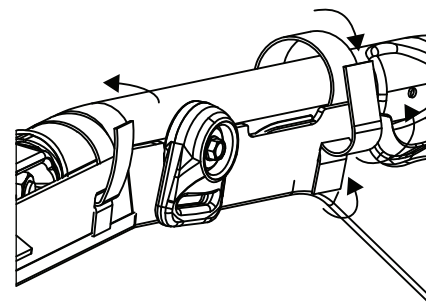
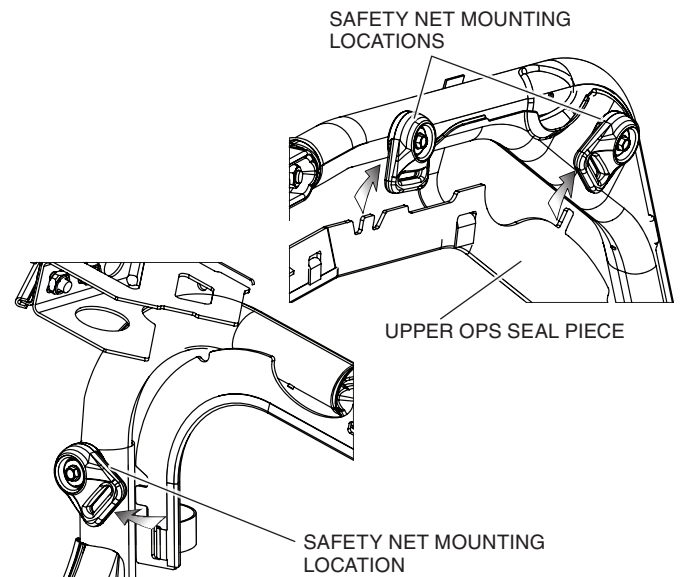

6. Install a door retainer to the left lower OPS cover and upper OPS seal piece with two #14 × 19 mm bolts as shown.

Wrap an assembled hose clamp through the cover-seal-retainer assembly, around frame tube as shown. Tighten the hose clamp.

- **Keep the hose clamp barrel inside of vehicle and be sure the rubber sleeve is in contact with the frame tube.**

Install the right door retainer using the same procedure.

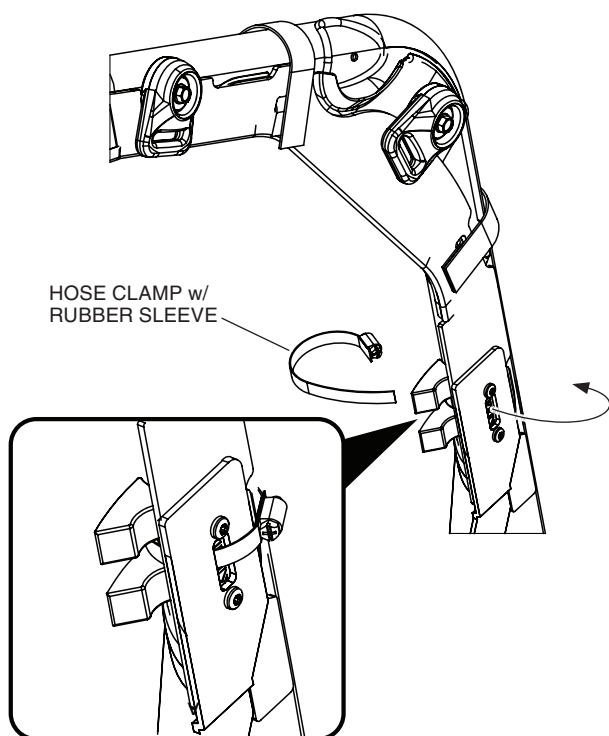
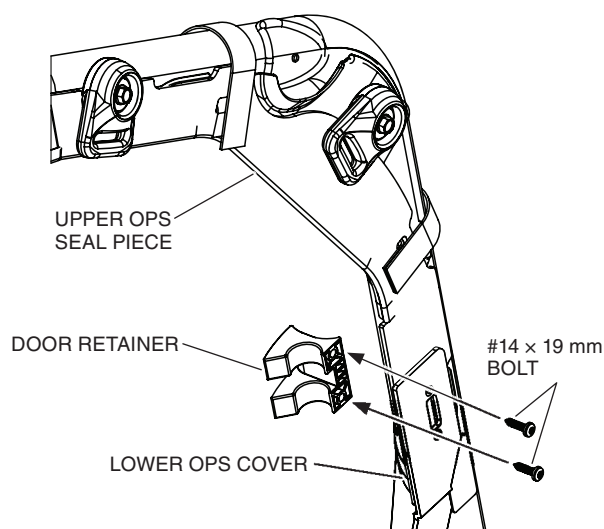

7. Slide the left door bracket over the metal tangs on the bottom of the door frame as shown.

Temporarily tape door bracket to the fabric door if necessary.

Install the right door bracket to the right fabric door frame using the same procedure.

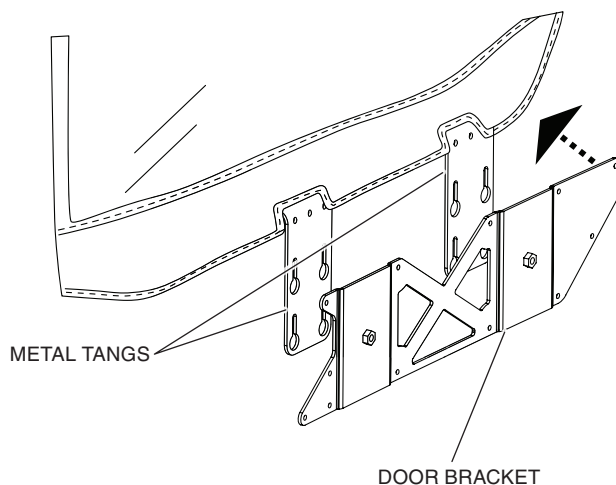

8. Place the assembled fabric door frame and bracket onto the left lower door so that the left door bracket is 10 mm from the front edge of the lower door as shown.

Using a punch or awl, mark the lower door through a hole at each end of the bracket as shown.

Remove the fabric door frame and door bracket.

Drill a 5 mm (3/16 in) hole at each mark.

Mark the right lower door using the same procedure.

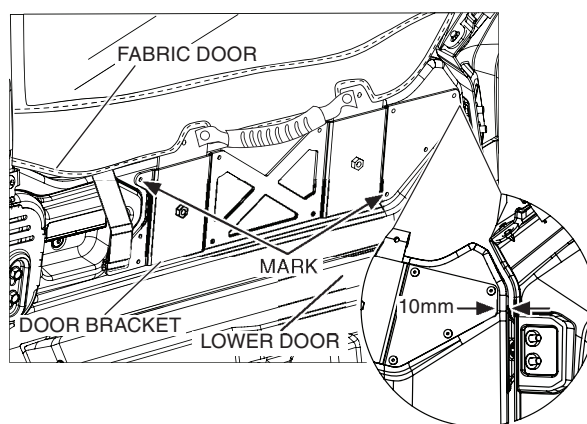

9. Align the left door bracket with the drilled holes.
Insert a bulb rivet into each drilled hole (do not set the rivets at this time) to hold the door bracket in place.

Check fit the left fabric door by placing it onto the left lower door and into the door bracket.

- **Be sure that the fabric door is centered between the front and rear OPS frame tubes and that it is well seated in the cover/seal retainer assembly.**

Once the door fit is verified, remove the fabric door and set the two placed bulb rivets in the door bracket with a rivet tool.

Drill a 5 mm (3/16 in) hole into the lower door at the ten remaining door bracket mounting hole locations.

Insert and set a bulb rivet into each mounting hole.

Install the right door bracket using the same procedure.

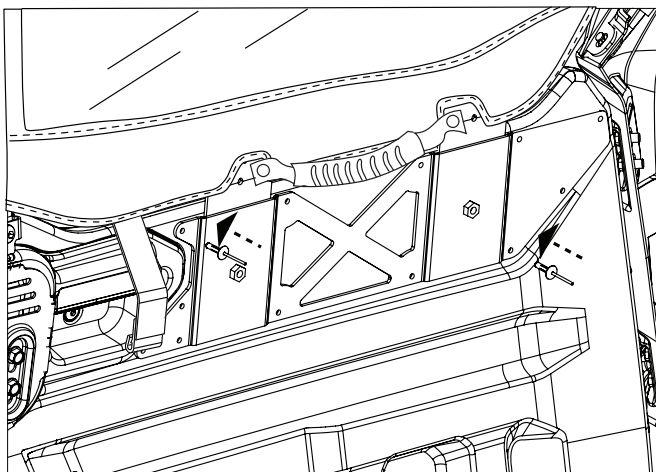

10. Open the left lower door and install the fabric door into the door bracket. Unzip the fabric zipper at the lower rear of the fabric door (not the clear window zipper) to access the interior door frame. Close the assembled door.

Perform a final check fit of the fabric door:

- **Make sure that the fabric door is seated firmly against the lower door and is centered between the front and rear OPS frame tubes.**
- **Make sure the upper door is seated in the Cover-Seal-Retainer assembly and there are no gaps between the fabric door and the OPS frame tubes.**

Once the fit is verified, use a transfer punch or similar to mark the top edge of the lower door through the hole in the door frame as shown.

Remove the fabric door.

Drill a 9.5 mm (3/8 in) hole into the top edge of the left lower door at the punch mark.

Mark and drill the top edge of the right lower door using the same procedure.

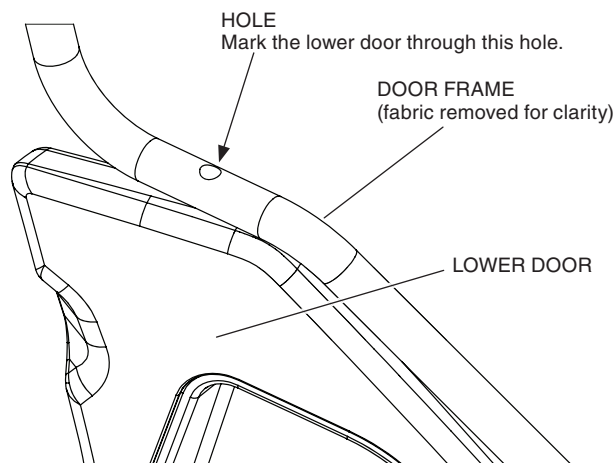

11. Slide the 8 mm flange nut onto the 6 × 40 mm bolt with the flange facing away from the bolt head as shown.

Thread the bolt with nut into the 6 mm jacknut, but do not compress the Jacknut.

Assemble a second jacknut using the same procedure.

Insert a jacknut assembly into the hole drilled into each lower door.

Using a 14 mm wrench, hold the flange nut to prevent it and the jacknut from turning. Tighten the 6 × 40 mm bolt using a 10 mm wrench.

- **Initially this will take minimal effort, but increased torque will be necessary as the Jacknut is compressed. Once the Jacknut is installed, remove the bolt and flange nut.**

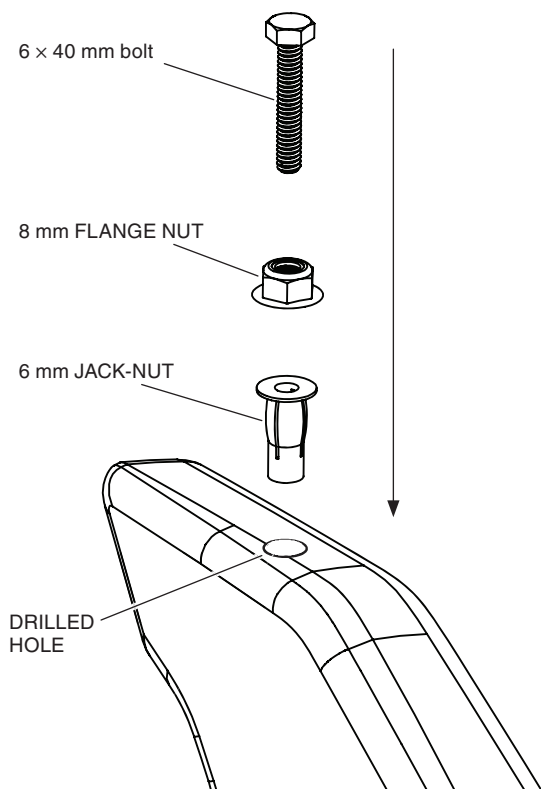

12. Clean and then dry the top edge of the left lower door.

Install the self-adhesive foam tape along the top of the left lower door so that it is centered under the fabric door frame as shown. Trim the tape so it does not cover the 6 mm jacknut.

Install the self-adhesive foam tape to the right lower door using the same procedure.

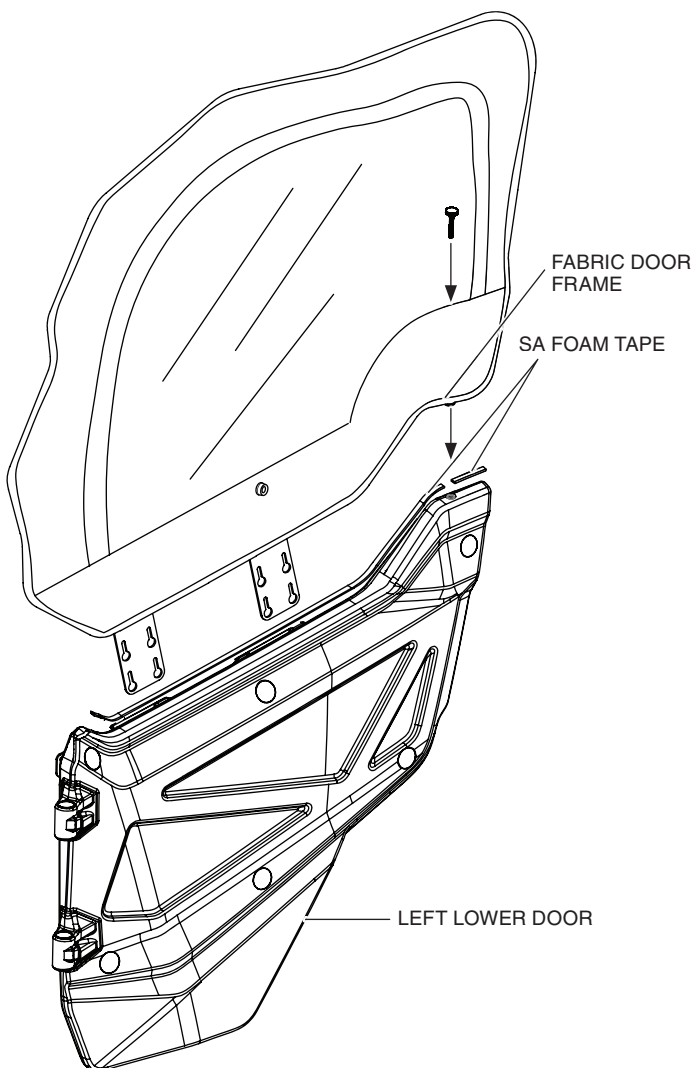

13. With the left lower door open, align the left fabric door with the left door bracket and firmly seat it onto the lower left door.

Install two 6 x 10 mm button head screws into the threaded center locations of the door bracket as shown.

Temporarily install the assembled thumbscrew through the door frame and into the jacknut on the top edge of the lower door as shown.

Close the zipper at the lower rear of the fabric door and then close the assembled door.

Check the fit of the assembled door.

- **If the fabric door does not sit correctly within the OPS frame, install a 6 mm fender washer between the fabric door frame and the lower door to adjust the fit.**

Tighten any loose fasteners.

Install and adjust the right fabric door using the same procedure.

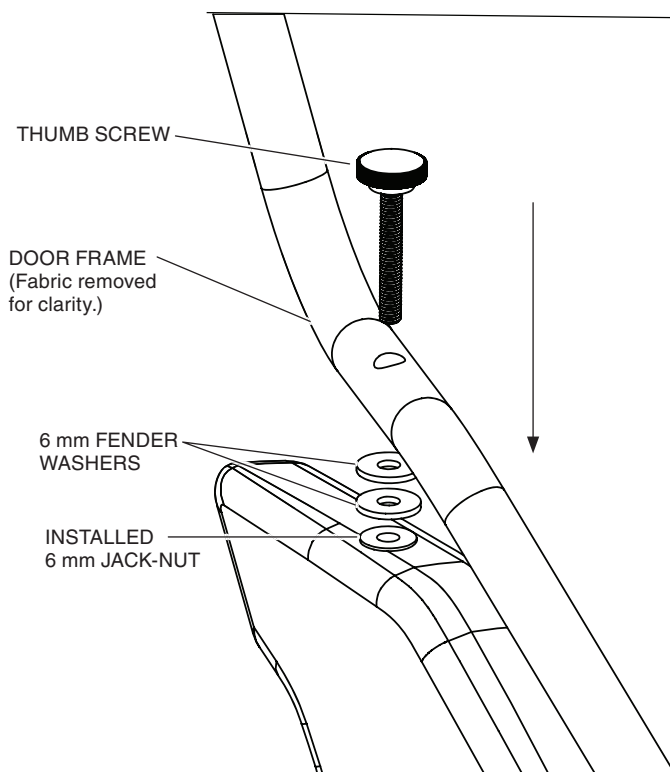
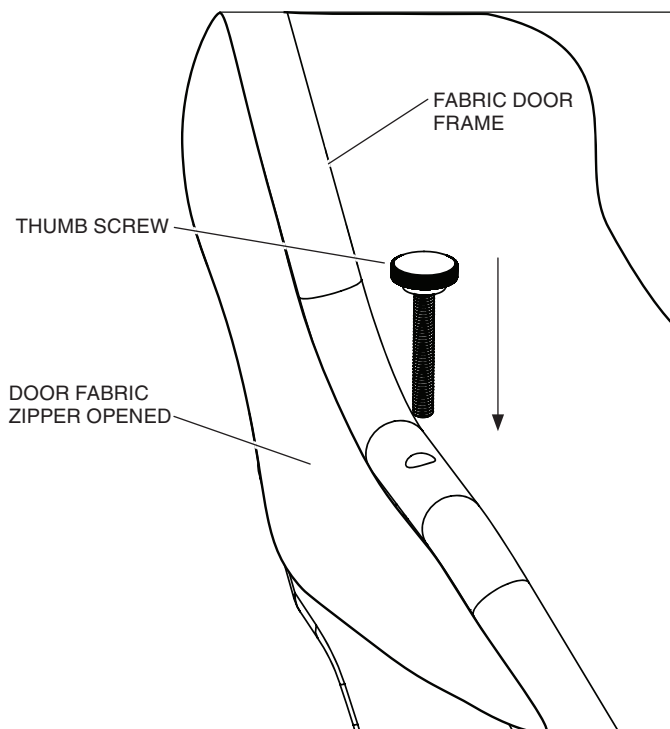
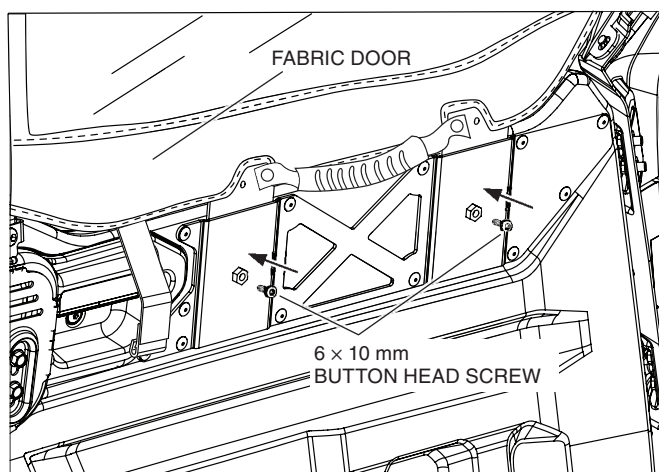

14. Attach the webbing strap with J-channel onto the left lower door handle as shown.
Do the same for the right door assembly.

