



# INSTALLATION INSTRUCTIONS

Accessory

**CARGO TRAY**  
**P/N 08L70-HL5-A40**

Application

**SXS500M2**

Publication No.

**MII 14948**

Issue Date

**December 2016**

**Honda Dealer: Please give a copy of these instructions to your customer.**

## PARTS LIST

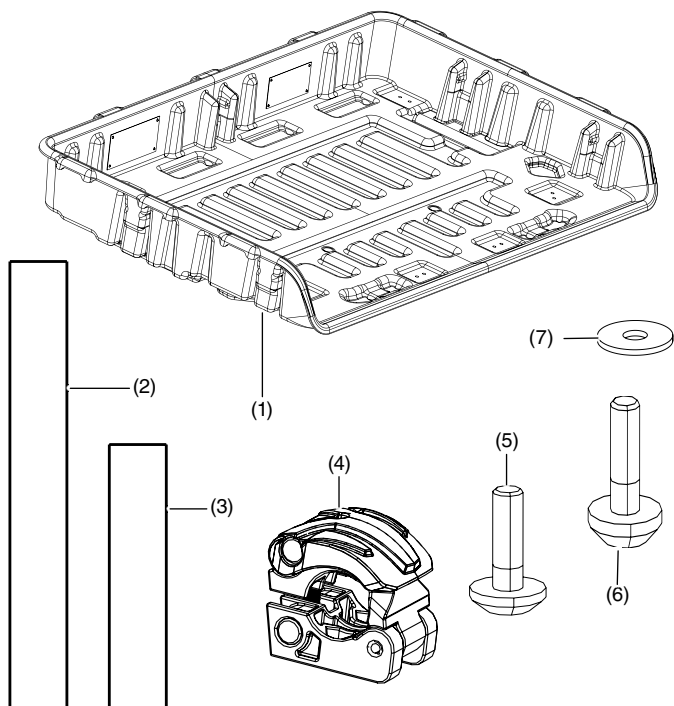

No.	Description	Qty
(1)	Cargo tray	1
(2)	Adhesive pad, 220 mm	3
(3)	Adhesive pad, 130 mm	3
(4)	Clamp	6
(5)	6 x 16 mm screw	4
(6)	6 x 20 mm screw	8
(7)	6 mm washer	12

## TOOLS AND SUPPLIES REQUIRED

5 mm hex bit socket

Torque wrench

## TORQUE CHART

Tighten all screws, bolts, and nuts to their specified torque values. Refer to the Service Manual for the torque values of the removed parts.

Item	N-m	kgf-m	lbf-ft
6 mm screw	4.5	0.46	3.3

## USE AND CARE INFORMATION

- Check the accessory mounts frequently and retighten if necessary.
- Replace this accessory with a new one if it is damaged or discolored excessively.
- When this accessory becomes dirty, rinse it thoroughly with cool water to remove loose dirt, and then wash with warm, soapy water and a clean cloth or sponge.
- Do not use a brush to clean this accessory as it may scratch the surface.
- Never use petroleum solvents such as gasoline, thinner, or benzene to clean this accessory. Also do not use acid or alkaline cleaners.

## NOTE

- Remove and discard the rubber shipping band from the clamps before installation of this accessory.

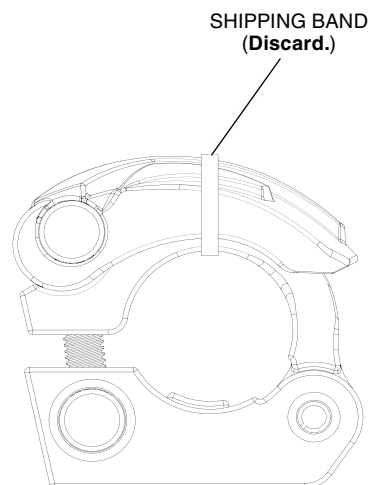

## INSTALLATION

1. Arrange the cargo tray so that the underside is facing up.
2. Clean the indicated pad attachment locations with isopropyl alcohol.

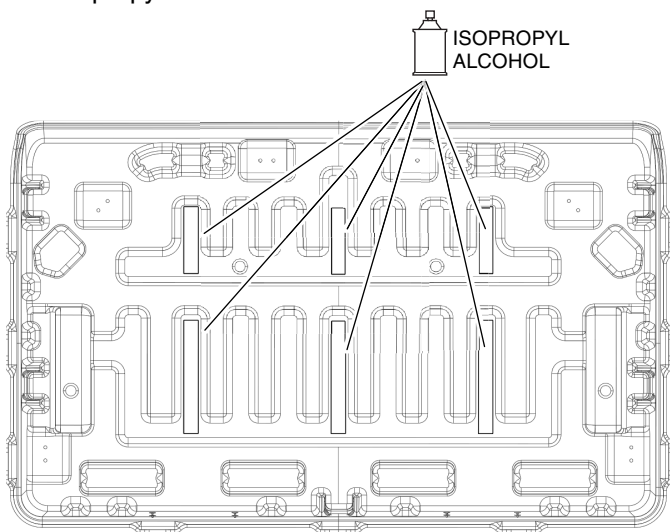

3. Remove the backing from the adhesive pads and apply them to the bottom of the cargo tray in the locations shown.

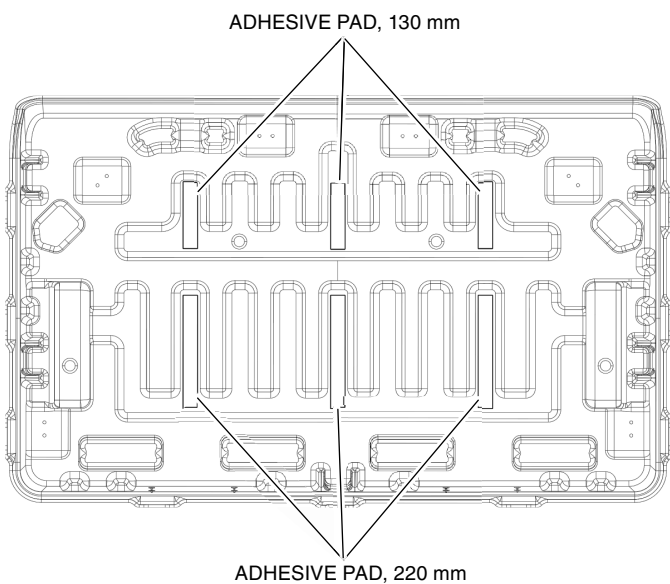

4. Install the clamps using the 6 mm washer, 6 x 16 mm screw, and 6 x 20 mm screw as shown. Orient and install the clamps as shown. Tighten the screws to the specification in the Torque Chart.

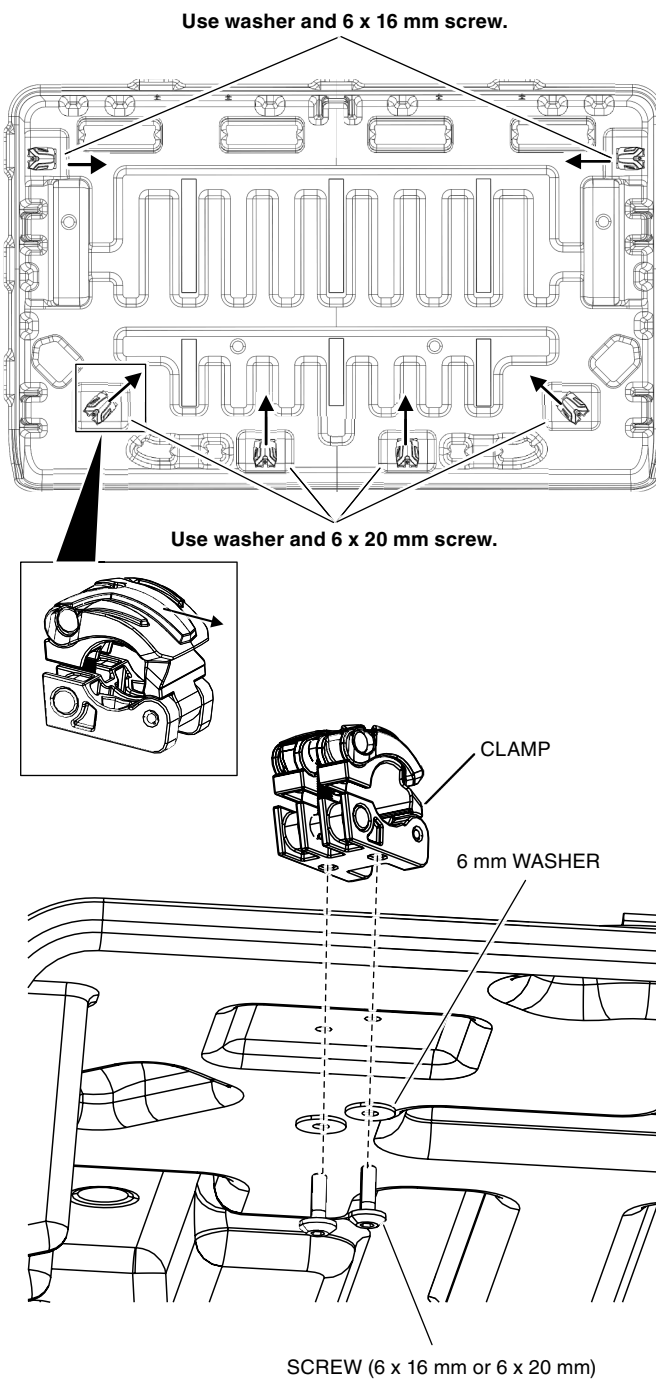

5. Open all six clamps on the underside of the cargo tray.
6. Center the cargo tray on top of the rear rack as shown.

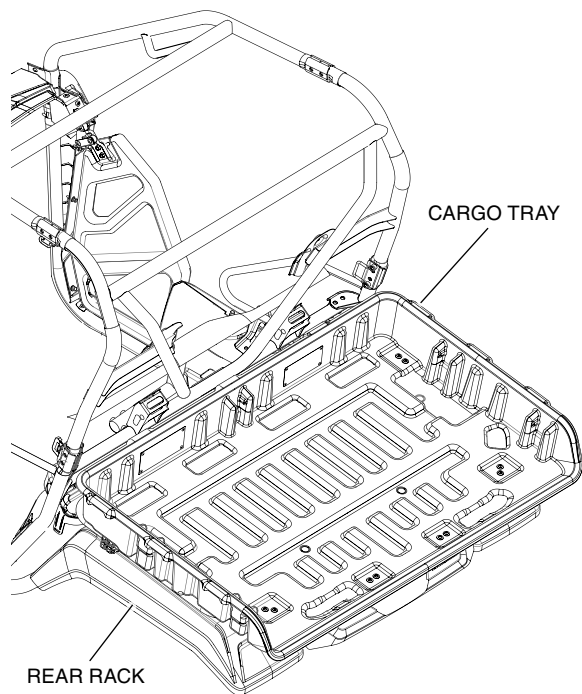

7. Align the clamps around the rack frame bars.
8. Adjust clamp tension by rotating the threaded arm clockwise to tighten, counter-clockwise to loosen.

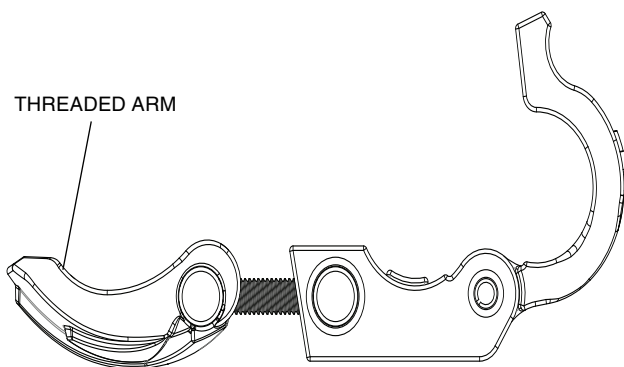

9. Swing the threaded arm over the top half of the clamp and snap the arm closed.

